

ARTOGL1

1" Step & Marker

IN-GRADE Series | 1.00" dia.
1.7W (150lm) | 12V | HK LED



Standard Direct View Low Voltage In-Grade LED Light:
ARTOGL1-RSTV in Black Powder Coated Brass



ARTOGL1-R360 in Bronze Powder Coated Brass
with Outer Sleeve



ARTOGL1-RGLR in Bronze Powder Coated Brass
installed profile with Glare Shield

FEATURES

- Ultra-compact 1" low voltage (12V) LED fixture for use as a Step, Marker, or In-Grade light in architectural outdoor and landscape applications.
- 1.7W integrated HK LED delivering 150 lumens. 2700 or 3000K CCT.
- Available in Standard Direct View, Glare Shield, Top Cover 360° and Top Cover 180°. Top Cover 360° and Top Cover 180° configurations meet Dark Sky requirements.
- Installs vertically or horizontally into masonry, stone, wood, pavers, decking—anywhere a 1" hole can be drilled or PVC sleeve cast.
- Wet Location Listed, IP68 Standard.
- Precision-machined from corrosion-resistant brass. Finishes include Black and Bronze.
- 360° rotation adjustment after installation.
- PVC Outer Sleeve simplifies installation in soil or poured concrete.
- Every fixture tested end of line for water tightness and light quality.

SPECIFICATIONS

Materials

Machined from billet 360 brass with 316 stainless steel hardware and silicone placement gaskets.

Finish

Superior corrosion resistant Black or Bronze powdercoat for a robust marine grade finish.

Optional Shields

Glare, Top Cover 360° and Top Cover 180° Shields available.

Voltage

12V AC/DC. Requires remote step down transformer.

Wattage

1.7W HK LED delivers 150 lumens.

Dimming

MLV or ELV Phase Control dimming.

Light Engine

Innovative HK LED Light engine. CRI 90 Standard. Standard CCT options are 2700K or 3000K.

Optics

Narrow (20°), Medium (35°), and Wide (60°) beam spread options available for Standard Direct View and Glare Shield Styles. Accepts a single optical accessory. Top Cover Style includes Shield Optimized optic.

Mounting

Mounts directly in ground, poured concrete, or any material where a 1" hole can be drilled, including any standard (schedule 40) 1" PVC pipe. Optional PVC Outer Sleeve is available to aid installation. (See page 4 for details)

Listings

CSA Listed for Wet Location, IP68 Standard. Standard Direct View and Top Cover 180° Shields are drive-over rated. Top Cover 360° and Top Cover 180° Shields meet Dark Sky requirements. RoHS Compliant.

ORDERING GUIDE

EXAMPLE: **ARTOGL1-RSDV-012V02W-27N-BK-OS-LVR**

MODEL	PHYSICAL OPTIONS				POWER				LIGHT				PHYSICAL OPTIONS	
ARTOGL1 ARTOG Series 1" In-Grade, Step & Marker Light Integrated HK LED	R				012V		02W							
	TYPE		STYLE		VOLTAGE		WATTAGE PER LIGHT		CCT		OPTICS		BK	Black Powder Coated Brass
	R	Round	SDV	Standard Direct View ¹	012V	12V AC	02W	1.7 Watts (150lm)	27	2700K	N	Narrow (20°) ¹	BZ	Bronze Powder Coated Brass
			GLR	Glare Shield ¹					30	3000K	M	Medium (35°) ¹		
			360	Top Cover 360° ²							W	Wide (60°) ¹		
		180	Top Cover 180° ²							S	Shield Optimized, use for 360 and 180 Styles ²			

¹ SDV (Standard Direct View) and GLR (Glare Shield) Styles compatible with user-preferred Optics. Choose N (Narrow), M (Medium), or W (Wide) Light Optic.

² 360 (Top Cover 360°), and 180 (Top Cover 180°) Styles compatible with S (Shield Optimized) Optic only. Choose S (Shield Optimized) Optic.

³ Accepts one optical accessory, SDV and GLR configurations only.

INSTALLED ACCESSORIES

INSTALLATION ACCESSORY OPTIONAL OPTIC ACCESSORIES

OS			
OS	Outer Sleeve, PVC	LVR	Hexcel Louver ³
		SOL	Solite Lens ³
		LSL	Linear Spread Lens ³

ADDITIONAL ACCESSORIES

SHIELD ACCESSORIES (Includes Optimized Optic)

OPTIONAL	
ASDV-G1	Standard Direct View
AGLR-G1	Glare Shield
A360-G1	Top Cover 360° ^{3,4}
A180-G1	Top Cover 180° ^{3,4}

OPTIC ACCESSORIES

NOT INSTALLED AT TIME OF ORDER	
ALVR-G1	Hexcel Louver
ALSL-G1	Linear Spread Lens
ASOL-G1	Solite Lens
OPK-G1	Optic Kit for ARTOGL1 Narrow, Medium, Wide

INSTALLATION ACCESSORIES

OPTIONAL	
AOS-G1	Outer Sleeve, PVC

⁴ Shield optimized optic included.

OUTDOOR MAGNETIC TRANSFORMERS (120V input/12VAC Output)

TRANSFORMERS (Go to [Accessories](#) for detailed specification)

EXAMPLE: **ATXM-150-OTR-SS**

ATXM				OTR-SS	
MODEL		WATTAGE (VA)		PRIMARY VOLTAGE (VAC)	
ATXM	Stainless steel, wet location outdoor magnetic transformer Multitap 12-15VAC Output MLV Dimming	150	150 Watts	OTR-SS	120V Only
		300	300 Watts		

PRODUCT DRAWINGS

STANDARD DIRECT VIEW
ARTOGL1-RSDV

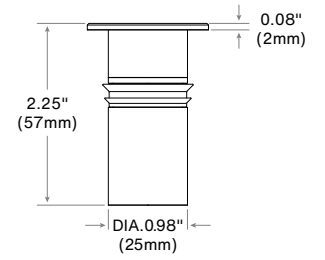
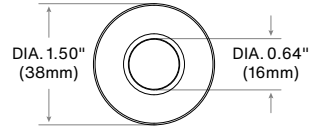
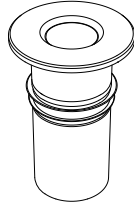

GLARE SHIELD
ARTOGL1-RGLR

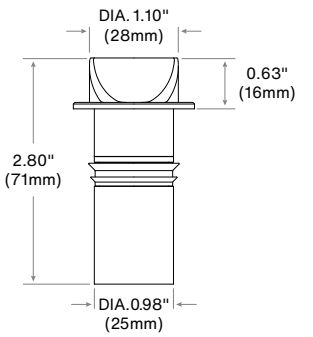
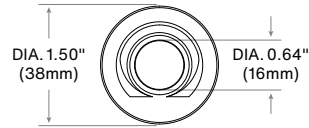
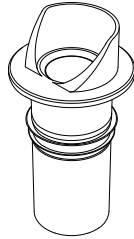

TOP COVER 360°
ARTOGL1-R360

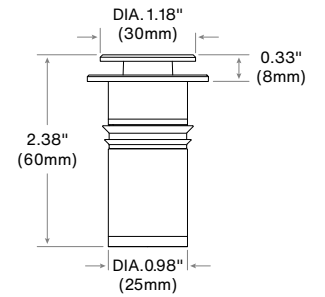
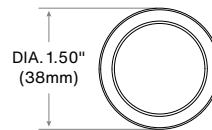
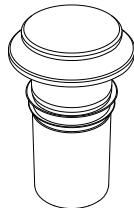

TOP COVER 180°
ARTOGL1-R180

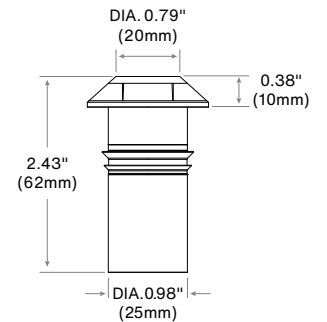
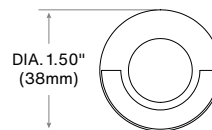
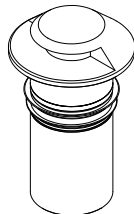

PRODUCT DRAWINGS

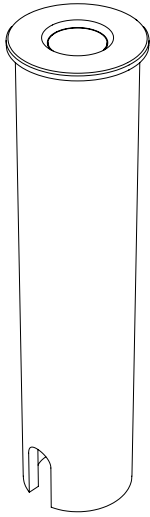

ARTOGL1-RSDV
with Outer Sleeve

AOS-G1

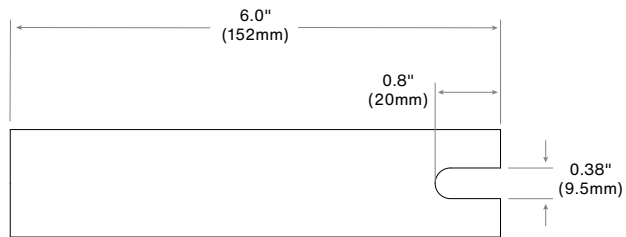
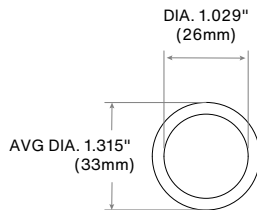
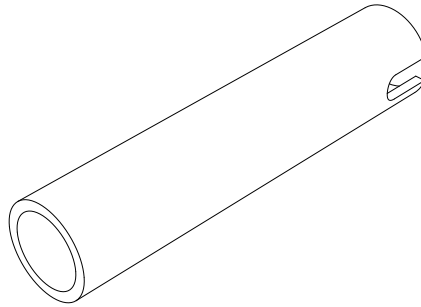

Cut From 1", Schedule 40, PVC Pipe

OPTIONS & ACCESSORIES

SHIELD ACCESSORIES

Standard
Direct View:

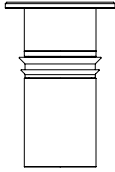

Fixture With ASDV-G1

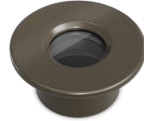

ASDV-G1

Glare
Shield:

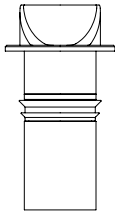

Fixture With AGLR-G1



AGLR-G1

Top Cover
360°:

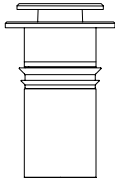

Fixture With A360-G1



A360-G1⁵

Top Cover
180°:

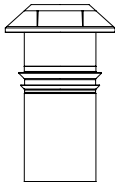

Fixture With A180-G1



A180-G1⁵

⁵Top Cover Shields ship with included Shield Optimized optic.

INSTALLATION ACCESSORIES

Outer
Sleeve:



Fixture With AOS-G1



AOS-G1

TRANSFORMER

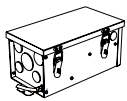

Magnitude Otter™ Landscape Transformer Series
150W or 300W, 120V input, multi-tap output, with light sensor and surge protection. (11.46" h x 6.132" w x 5.69" d)

ATXM-150-OTR-SS
ATXM-300-OTR-SS

WIRING

For more information visit: lightingshrink.com



LightingShrink® Crimper
HK Lighting requires use of the LightingShrink crimper system for product warranty.

ALSC-CR



LightingShrink® Connector Small (Blue) - 20 pack

ALSC-SM20



LightingShrink® Connector Medium (Yellow) - 20 pack

ALSC-MD20

PHOTOMETRY & ENERGY DATA

BASE FIXTURE (No Cover Accessory)

ARTOGL1 (Narrow)

Input Power	1.66W
Color Temperature (CCT)	3000K
Color Rendering Index (Ra)	90+
Beam Angle	21.84°
Max. Candlepower	810 cd
Delivered Lumens	140 lm
Efficacy	84.12 lm/W

Polar Graph - Intensity

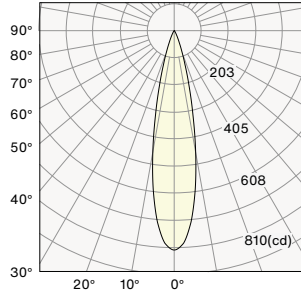

Cone of Light - Illuminance

Center Beam (fc)	Beam Diameter	Distance
202.50	0.77'	2.0'
50.63	1.54'	4.0'
22.50	2.31'	6.0'
12.66	3.09'	8.0'
8.10	3.86'	10.0'

1/2 Beam Angle: 21.84°

ARTOGL1 (Medium)

Input Power	1.67W
Color Temperature (CCT)	3000K
Color Rendering Index (Ra)	90+
Beam Angle	33.49°
Max. Candlepower	371 cd
Delivered Lumens	132 lm
Efficacy	79.22 lm/W

Polar Graph - Intensity

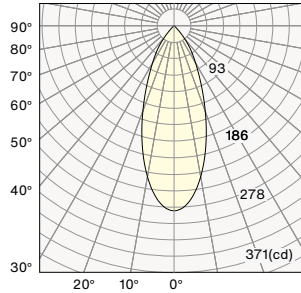

Cone of Light - Illuminance

Light Level (fc)	Beam Diameter	Distance
92.75	1.20'	2.0'
23.19	2.41'	4.0'
10.31	3.61'	6.0'
5.80	4.81'	8.0'
3.71	6.02'	10.0'

1/2 Beam Angle: 33.49°

ARTOGL1 (Wide)

Input Power	1.67W
Color Temperature (CCT)	3000K
Color Rendering Index (Ra)	90+
Beam Angle	59.44°
Max. Candlepower	153 cd
Delivered Lumens	131 lm
Efficacy	78.57 lm/W

Polar Graph - Intensity

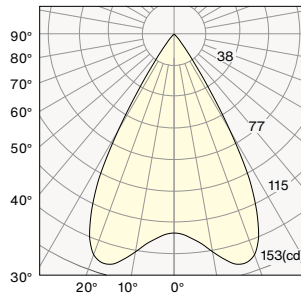

Cone of Light - Illuminance

Light Level (fc)	Beam Diameter	Distance
31.75	2.28'	2.0'
7.94	4.57'	4.0'
3.53	6.85'	6.0'
1.98	9.13'	8.0'
1.27	11.42'	10.0'

1/2 Beam Angle: 59.44°

PHOTOMETRY & ENERGY DATA

FIXTURE (with Cover Accessory)

ARTOGL1 180

Input Power	1.66W
Color Temperature (CCT)	3000K
Color Rendering Index (Ra)	90+
Delivered Lumens	6 lm
Efficacy	3.62 lm/W

Peak Intensity Polar Plot

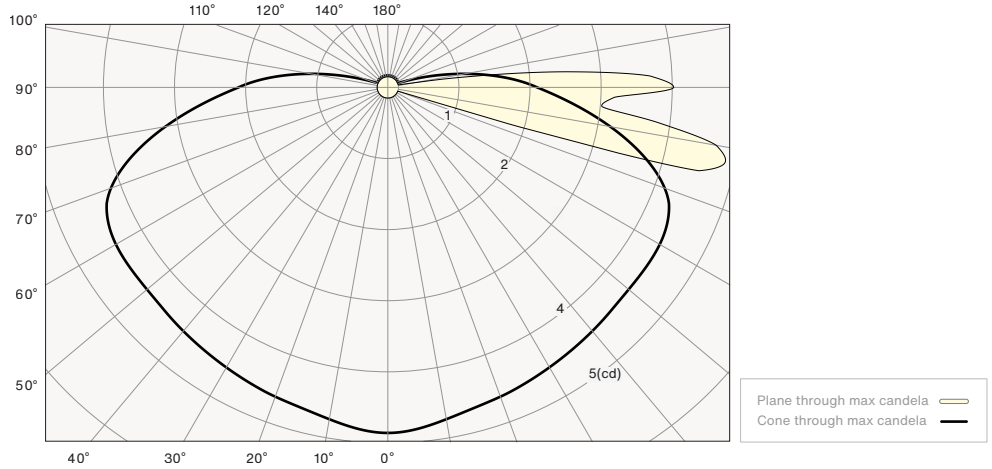

ARTOGL1 360

Input Power	1.66W
Color Temperature (CCT)	3000K
Color Rendering Index (Ra)	90+
Delivered Lumens	5 lm
Efficacy	3.01 lm/W

Peak Intensity Polar Plot

